

FOR SUBLEASE

6376 CORLEY ROAD, SUITE A, NORCROSS, GA 30071



PROPERTY INFORMATION

SUITE A SIZE	35,796 SF Available
OFFICE	2,112 SF
WAREHOUSE	33,684 SF
CLEAR HEIGHT	22'
BAY SIZE	40' x 43'8"
DOCK-HIGH DOORS	7 (Seven)
DRIVE-IN DOORS	1 (One)
SUBLEASE TERM	Expires 03/31/2029
UNIT LOCATION	End Cap Suite
LOCATION	±0.3 mi to Jimmy Carter Blvd ±1 mi to Buford Hwy (US-23) ±1.1 mi to Peachtree Ind Blvd ±2.5 mi to I-85 ±5 mi to I-285

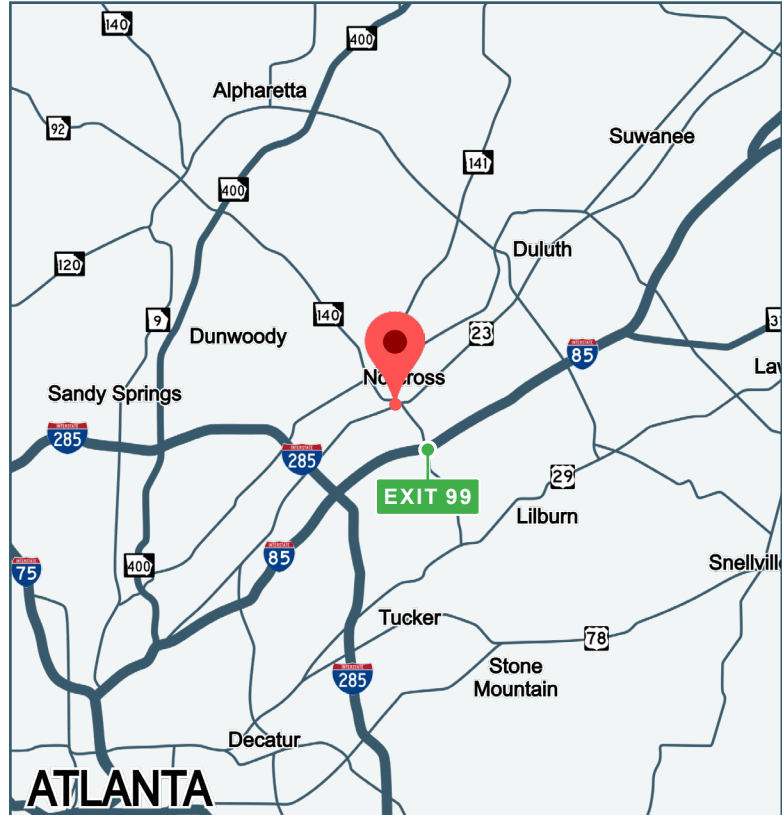

All information contained herein is believed to be accurate but is not warranted. This offer is subject to errors, omissions, prior sale or withdrawal.



Hughes Commercial Real Estate, Inc.
8215 Roswell Road, Building 700
Atlanta, GA 30350
770-559-1099 | hughes-cre.com

Matt Nelsen
404-431-0971
matt@hughes-cre.com

FOR SUBLEASE

6376 CORLEY ROAD, SUITE A, NORCROSS, GA 30071

SUITE A INFORMATION

- 35,796 SF Total
- 2,112 SF Office
- 33,684 SF Warehouse
- 22' Clear Height
- 7 Dock-High Doors
- 1 Drive-In Door
- 40' x 43'8" Bay Size
- End Cap Suite

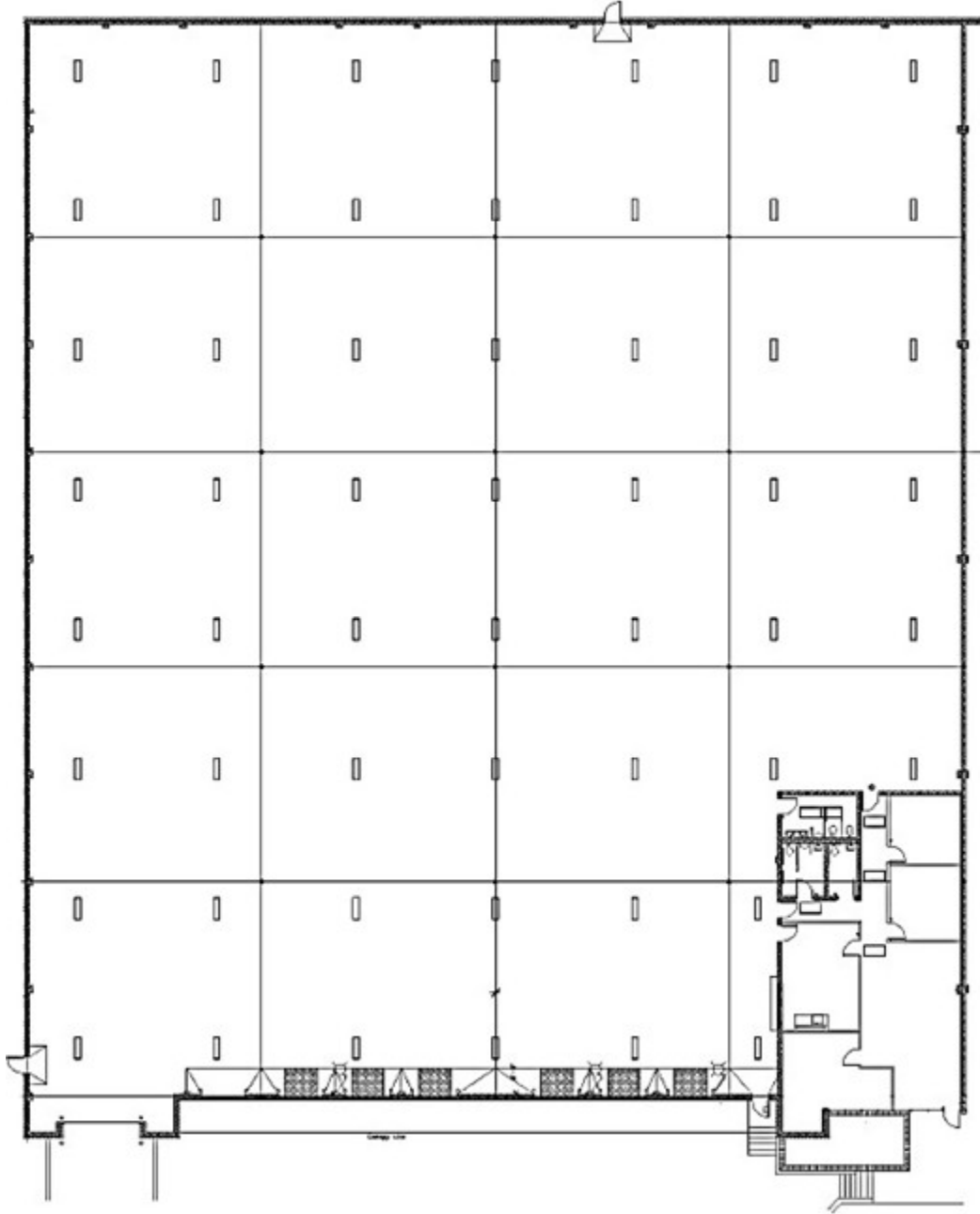

All information contained herein is believed to be accurate but is not warranted. This offer is subject to errors, omissions, prior sale or withdrawal.



Hughes Commercial Real Estate, Inc.
8215 Roswell Road, Building 700
Atlanta, GA 30350
770-559-1099 | hughes-cre.com

Matt Nelsen
404-431-0971
matt@hughes-cre.com