

# FOR LEASE

3100-3150 ENGINEERING PARKWAY  
ALPHARETTA, GA 30004

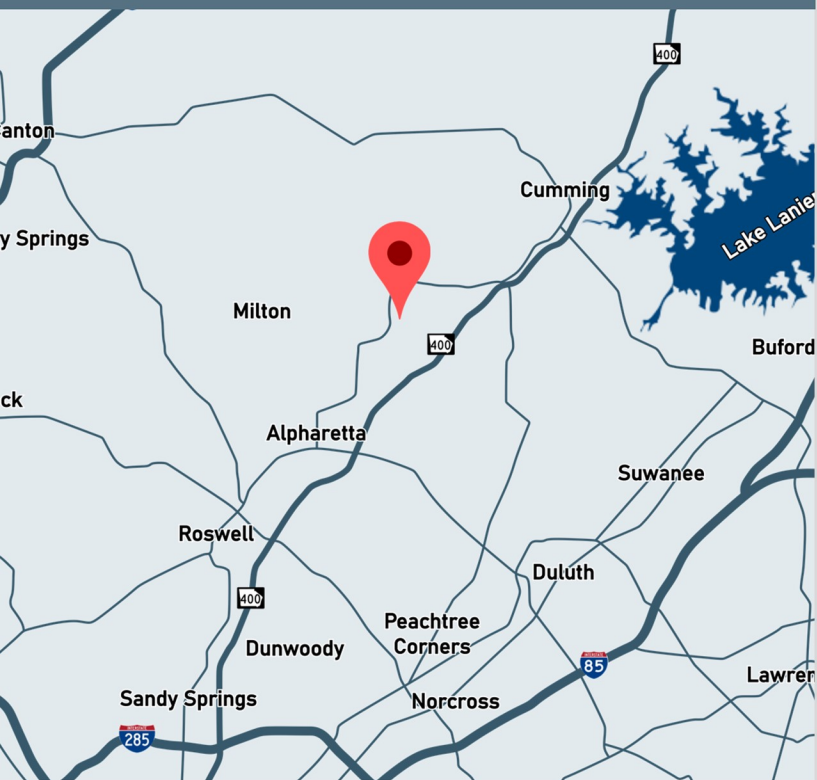

## LOCATION MAP



## PROPERTY INFORMATION

- +/-35,000 SF Multi-Tenant Industrial Building
- One Industrial Suite Available:
  - **Suite 3130:** +/-6,000 SF
- Dock-High Loading
- +/-20' Clear Height
- Sprinklered
- Located within Grassland Industrial Park, just off Grassland Parkway
- +/-0.8 Miles to GA-9 (Atlanta Hwy)
- +/-3.6 Miles to GA-400



**Hughes Commercial Real Estate, Inc.**  
8215 Roswell Road, Building 700  
Atlanta, GA 30350  
770-559-1099

**Tommy Hughes**  
404-218-5080  
tommy@hughes-cre.com

**James Hicks**  
404-304-2386  
james@hughes-cre.com

**FOR LEASE**

**3100-3150 ENGINEERING PARKWAY  
ALPHARETTA, GA 30004**



**Hughes Commercial Real Estate, Inc.**  
8215 Roswell Road, Building 700  
Atlanta, GA 30350  
770-559-1099

**Tommy Hughes**  
404-218-5080  
tommy@hughes-cre.com

**James Hicks**  
404-304-2386  
james@hughes-cre.com

All information contained herein is believed to be accurate but is not warranted. This information is subject to errors, omissions or withdrawal.

# FOR LEASE

3100-3150 ENGINEERING PARKWAY  
ALPHARETTA, GA 30004

## FLOOR PLAN

### SUITE 3130

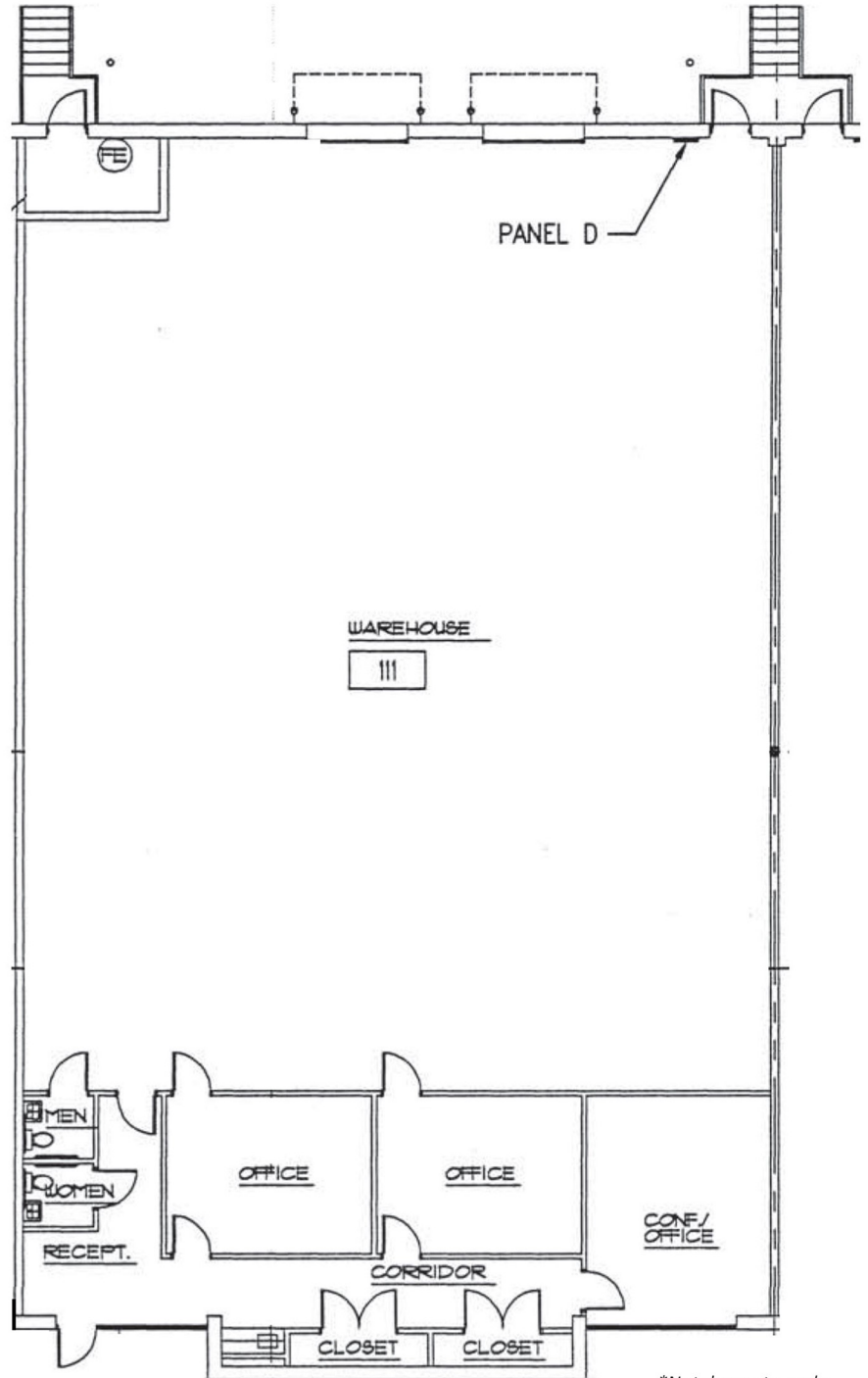

*\*Not drawn to scale*

#### SUITE DETAILS

+/-6,000 SF Total  
+/-5,200 SF Warehouse  
+/-800 SF Office  
Two (2) Dock High Doors



**Hughes Commercial Real Estate, Inc.**  
8215 Roswell Road, Building 700  
Atlanta, GA 30350  
770-559-1099

**Tommy Hughes**  
404-218-5080  
tommy@hughes-cre.com

**James Hicks**  
404-304-2386  
james@hughes-cre.com

All information contained herein is believed to be accurate but is not warranted. This information is subject to errors, omissions or withdrawal.

# FOR LEASE

3100-3150 ENGINEERING PARKWAY  
ALPHARETTA, GA 30004

## LOCAL AREA MAP

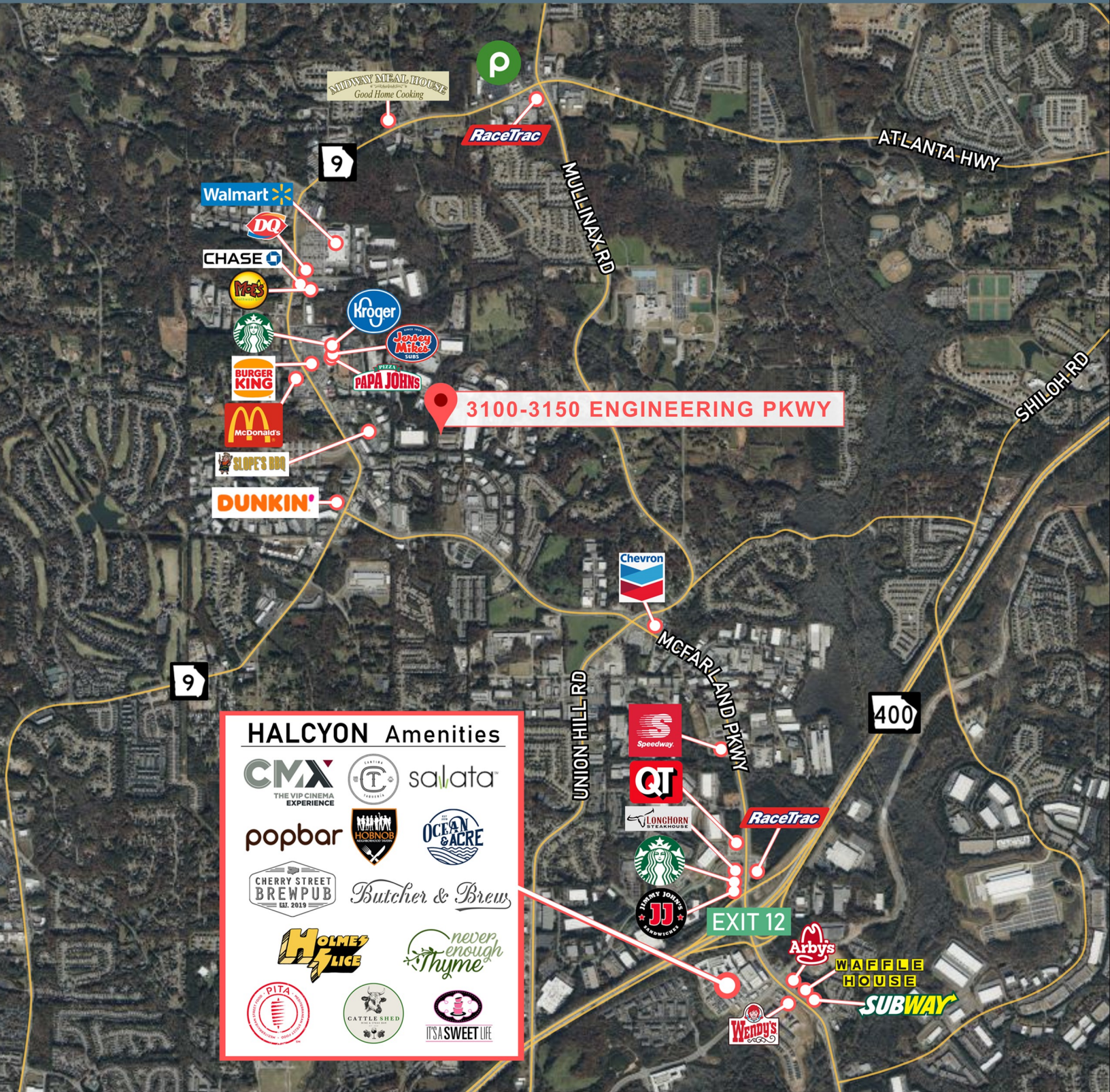

Hughes Commercial Real Estate, Inc.  
8215 Roswell Road, Building 700  
Atlanta, GA 30350  
770-559-1099

Tommy Hughes  
404-218-5080  
tommy@hughes-cre.com

James Hicks  
404-304-2386  
james@hughes-cre.com

All information contained herein is believed to be accurate but is not warranted. This information is subject to errors, omissions or withdrawal.